

zipato®

SMART SMOKE SENSOR

QUICK INSTALLATION GUIDE v1.0



TRADEMARKS

Zipato and the Zipato logo are registered Trademarks. All other product names mentioned herein may be trademarks or registered trademarks of their respective companies.

NOTICE

Although Zipato has attempted to ensure the accuracy of the content of this manual, it is possible that this document may contain technical inaccuracies, typographical, or other errors. Zipato assumes no liability for any error in this publication, and for damages, whether direct, indirect, incidental, and consequential or otherwise, that may result from such error, including, but not limited to loss of data or profits.

Zipato provides this publication "as is" without warranty of any kind, either express or implied, including, but not limited to implied warranties of merchantability or fitness for a particular purpose. The published information in the manual is subject to change without notice. Zipato reserves the right to make changes in the product design, layout, and driver revisions without notification to its users. This version of the Installation guide supersedes all previous versions.

INTRODUCTION

This product is a Smart Smoke Sensor, a warning device. It can not sense gas, heat, flame and cannot prevent or put out the fire. It is capable of real time detection of smoke, visible particles (smoldering fire) faster than ionization smoke alarms. Red LED flashes rapidly and detectors sound alarm once the smoke/fire danger has been detected. Smoke alarms should be installed in all rooms where fire may happen.

SPECIFICATION

Working voltage: DC3V (CR123A Lithium battery)
Static current: $\leq 20\mu\text{A}$
Alarm current: $\leq 60\text{mA}$
Alarm sound: 85dB/1m
Networking: Z-Wave
Working temperature: $-10^{\circ}\text{C} \sim +50^{\circ}\text{C}$
Humidity: $\leq 95\% \text{RH}$
Dimensions: 60 x 60 x 49.2 mm

WARNINGS

1. Specifically designed for home use.
2. Avoid installation in bathrooms and other very humid places, dusty or greasy areas, or very airy place with air conditioning, ceiling fans, etc.
3. Keep Smoke Sensor clean. Recommended to clean every 6 months with soft brush.
4. Effective life span is 10 years.



Alarm

Test button and
LED indicator.



Bracket

INSTALLATION

1| CEILING MOUNTING

The preferred location to install the sensor is in the centre of the ceiling because smoke, heat and combustion products rise to the ceiling and will lateral spread. Keep at least 30 cm

distance from lights or decoration, and at least 15 cm from walls. If room is more than 12 meters wide please install at 2 sides of the room.

2| SLOPING CEILING MOUNTING

If ceiling is sloping, please install the smoke alarm at horizontal distance 90 cm away from the ceiling top.

INSTALLATION STEP 1:

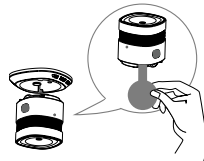

Anticlockwise rotate the bracket out from the installation base, then remove the battery insulating strip to make the sensor to power on.

INSTALLATION STEP 2:

1. DEVICE INCLUSION

- Click [Add] icon in Z-Wave PC Controller Program.
- Press the Net_Button 3 times within 1.5s, Green LED is blinking 3 times within 1 second.
- If Inclusion Process is successful, Green led will turn off.

2. DEVICE EXCLUSION

- Click [Remove] icon in Z-Wave PC Controller Program
- Press the Net_Button 3 times within 1.5s
- If Exclusion Process is successful, Green led is Blinking 6 times, then turn off.

3. DEVICE TEST MODE

If Inclusion process is successful, Press Test_Button to test if the device is working normally. Red LED blinks 3 times when smoke is detected.

4. DEVICE DETECTION MODE

If Inclusion process is successful, the device will report alarm information if detect the status change of smoke and no smoke. Red LED blinks quickly when smoke is detected.

5. DEVICE FACTORY RESET

- Long press Net_Button while installing batteries in HS1SA-Z.
- Device Reset Locally notification is Transmitted.
- Please use this procedure only when the network primary controller is missing or otherwise inoperable.

6. ASSOCIATION & ASSOCIATION GROUP INFORMATION

- Lifeline between controller and HS1SA-Z
- Supported command classes
Battery report, Notification report, and Device Reset Locally notification, Binary report.
- Maximum supported nodes are 5.
- Association Group description
 - Association group 1: Lifeline association group
Include command classes: Battery report, Notification report, and Device Reset Locally notification, Binary report.
 - Association group 2: Root Device group(Binary Sensor)
Binary Sensor Command Class: Compatible with 300 series
1-Binary Sensor reports status of smoke or no smoke via Lifeline.
2-When the sensor detects status change between smoke and no smoke, the device will be triggered.
 - Association group 3: Root Device group(Notification)
1-Notification reports reports status of detect smoke or no

smoke via Lifeline.

- 2-When the sensor detects status change between smoke and no smoke, the device will be triggered.

7. NOTIFICATION REPORT

- Press or release test button, or smoke status is changed (smoke detected or no smoke detected) , Notification Report is transmitted

NOTIFICATION TYPE	EVENT
Smoke Alarm (0x01)	Previous Events cleared (0x00)
	Smoke detected, Unknown Location(0x02)

8. BATTERY REPORT

- Battery Report is transmitted when power on the device.
- Battery Report is transmitted once a day.
- Battery Report is transmitted when the battery falls less than 10%

BATTERY VOLTAGE	BATTERY LEVEL
2.4V ~ 3.0V	10~ 100 (%)
Under 2.4V	0xFF

9. WAKE UP NOTIFICATION

- Wake up Notification is transmitted every 24 hours by default.
- Wake up Notification is transmitted after Notification Report is Transmitted

INSTALLATION STEP 3:

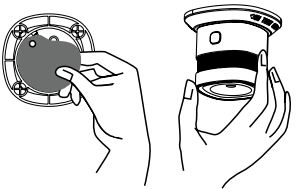

Remove the double-sided adhesive membrane on the mounting bracket and fit the smoke sensor into the bracket by rotating it.

STATUS & TROUBLESHOOTING

STATUS	LIGHT	ALARM SUND
Normal	Red LED flashes every 53 seconds	No
Testing	Red LED flashes quickly	Rapid beeps
Alarm	Red LED flashes quickly	Rapid beeps
Mute mode	Red LED flashes every 10 seconds	No
Low power	Red LED flashes every 40 seconds	Beep every 40 seconds
Fault	Red LED flashes every 40 seconds	Beep every 40 seconds

Please refer to the following situations if the Smoke Sensor isn't working properly:

1. If battery reaches service life, please replace it
2. Fault affected by dust or oil, please clean it
3. Check if the sensor is properly placed into bracket

MUTE FUNCTION

Please make sure that there is no real danger of fire when using the mute function. Under known and non-fire alarm conditions, please do not block or by any other form prohibit alarming. Press the "Test/Mute" button to lower sensitivity and relieve alarm.

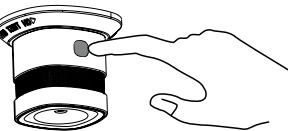

Press test button for 3 seconds until alarm sounds. Do this test at least once a week.

BATTERY REPLACEMENT



Turn right to dismantle the mounting base of the device. Replace the battery correctly, following the battery positive and negative electrode. Turn left to install the mounting base of the device (before install the mounting base, you should must insert battery firstly , otherwise the mounting base will not be fixed). Please pay attention to environmental protection and dispose used batteries properly.

LIMITED PRODUCT WARRANTY

→ GENERAL TERMS

Nothing in this Limited Product Warranty affects your statutory rights as a consumer.

The Limited Product Warranty set forth below is given by Tri plus grupa d.o.o. (Europe) (herein referred to as "ZIPATO"). This Limited Product Warranty is only effective upon presentation of the proof of purchase. Upon further request by ZIPATO, this warranty card has to be presented, too.

EXCEPT AS EXPRESSLY SET FORTH IN THIS LIMITED WARRANTY, ZIPATO MAKES NO OTHER WARRANTIES, EXPRESS OR IMPLIED, INCLUDING ANY IMPLIED WARRANTIES OF MERCHANTABILITY AND FITNESS FOR A PARTICULAR PURPOSE. ZIPATO EXPRESSLY DISCLAIMS ALL WARRANTIES NOT STATED IN THIS LIMITED WARRANTY. ANY IMPLIED WARRANTIES THAT MAY BE IMPOSED BY LAW ARE LIMITED IN DURATION TO THE LIMITED WARRANTY PERIOD. TO THE EXTENT ALLOWED BY LOCAL LAW, THE REMEDIES IN THIS WARRANTY STATEMENT ARE CUSTOMER'S SOLE

AND EXCLUSIVE REMEDIES AGAINST ZIPATO. THEY DO NOT, HOWEVER, AFFECT OR RESTRICT THE RIGHTS YOU HAVE AGAINST THE BUSINESS YOU BOUGHT A ZIPATO PRODUCT FROM. IN NO EVENT WILL ZIPATO BE LIABLE FOR LOSS OF DATA OR FOR INDIRECT, SPECIAL, INCIDENTAL, CONSEQUENTIAL (INCLUDING LOST PROFIT OR DATA), OR OTHER DAMAGE, WHETHER BASED IN CONTRACT, TORT, OR OTHERWISE. HOWEVER, NOTHING IN THIS AGREEMENT LIMITS ZIPATO'S LIABILITY TO YOU (I) IN THE EVENT OF DEATH OR PERSONAL INJURY TO THE EXTENT RESULTING FROM ZIPATO'S NEGLIGENCE, OR (II) TO THE EXTENT RESULTING FROM ANY FRAUDULENT MISREPRESENTATION ON THE PART OF ZIPATO, OR (III) TO THE EXTENT ARISING UNDER PART 1 OF THE CONSUMER PROTECTION ACT 1987 OF THE UNITED KINGDOM. SOME STATES OR COUNTRIES DO NOT ALLOW: (1) A DISCLAIMER OF IMPLIED WARRANTIES; (2) A LIMITATION ON HOW LONG AN IMPLIED WARRANTY LASTS OR THE EXCLUSION; OR (3) LIMITATION OF INCIDENTAL OR CONSEQUENTIAL DAMAGES FOR CONSUMER PRODUCTS. IN SUCH STATES OR COUNTRIES, SOME EXCLUSIONS OR LIMITATIONS OF THIS LIMITED WARRANTY MAY NOT APPLY TO YOU. THIS LIMITED WARRANTY GIVES YOU SPECIFIC LEGAL RIGHTS. YOU MAY ALSO HAVE OTHER RIGHTS THAT MAY VARY

FROM STATE TO STATE OR FROM COUNTRY TO COUNTRY. YOU ARE ADVISED TO CONSULT APPLICABLE STATE OR COUNTRY LAWS FOR A FULL DETERMINATION OF YOUR RIGHTS.

This Limited Product Warranty applies to ZIPATO branded hardware products (collectively referred to as "ZIPATO Hardware Products") sold by ZIPATO (Europe), its European subsidiaries, affiliates, authorized resellers, or country distributors (collectively referred to as "ZIPATO Resellers") with this Limited Product Warranty.

The term "ZIPATO Hardware Product" is limited to the hardware components and all its internal components including firmware.

The term "ZIPATO Hardware Product" DOES NOT include any software applications or programs.

→ GEOGRAPHICAL SCOPE OF THE LIMITED PRODUCT WARRANTY

This Limited Product Warranty is applicable to Hardware Products sold by Zipato Resellers in all countries listed at the beginning of this document under the heading "Countries in which this ZIPATO Limited Product Warranty applies". The Limited Product Warranty will be honored in any country where

ZIPATO or its authorized service providers offer warranty service subject to the terms and conditions set forth in this Limited Product Warranty. However, warranty service availability and response times may vary from country to country and may also be subject to registration requirements.

→ LIMITATION OF PRODUCT WARRANTY

ZIPATO warrants that the products described below under normal use are free from material defects in materials and workmanship during the Limited Product Warranty Period set forth below ("Limited Product Warranty Period"), if the product is used and serviced in accordance with the user manual and other documentation provided to the purchaser at the time of purchase (or as amended from time to time).

ZIPATO does not warrant that the products will operate uninterrupted or error-free or that all deficiencies, errors, defects or non-conformities will be corrected.

This warranty shall not apply to problems resulting from: (a) unauthorized alterations or attachments; (b) negligence, abuse or misuse, including failure to operate the product in accordance with specifications or interface requirements; (c) improper handling; (d) failure of goods or services not obtained

from ZIPATO or not subject to a then-effective ZIPATO warranty or maintenance agreement; (e) improper use or storage; or (f) fire, water, acts of God or other catastrophic events. This warranty shall also not apply to any particular product if any ZIPATO serial number has been removed or defaced in any way. ZIPATO IS NOT RESPONSIBLE FOR DAMAGE THAT OCCURS AS A RESULT OF YOUR FAILURE TO FOLLOW THE INSTRUCTIONS FOR THE ZIPATO HARDWARE PRODUCT.

→ LIMITED PRODUCT WARRANTY PERIOD

The Limited Product Warranty Period starts on the date of purchase from ZIPATO. Your dated sales or delivery receipt, showing the date of purchase of the product, is your proof of the purchase date. You may be required to provide proof of purchase as a condition of receiving warranty service. You are entitled to warranty service according to the terms and conditions of this document if a repair to your ZIPATO branded hardware is required within the Limited Product Warranty Period.

[Other than in respect of products for domestic use (in particular those listed in the first and last boxes in the table below), this Limited Product Warranty extends only to the

original end user purchaser of this ZIPATO Hardware Product and is not transferable to anyone who obtains ownership of the ZIPATO Hardware Product from the original end-user purchaser.

→ PRODUCT WARRANTY PERIOD TABLE

PRODUCT TYPE	Smart Smoke Sensor
PRODUCT WARRANTY PERIOD	One (1) year

IMPORTANT

The content of "Product Type" listed above is subject to change; please refer to the www.zipato.com for latest update.

→ PERFORMANCE OF THE LIMITED PRODUCT WARRANTY

If a product defect occurs, ZIPATO's sole obligation shall be to repair or replace any defective Zipato Hardware Product free of charge provided it is returned to an Authorized ZIPATO Service Centre during the Limited Warranty Period. Such repair or replacement will be rendered by ZIPATO at an Authorized

ZIPATO Service Centre. All component parts or hardware products that are replaced under this Limited Product Warranty become the property of ZIPATO. The replacement part or product takes on the remaining Limited Warranty Period of the replaced part or product. The replacement product need not be new or of an identical make, model or part; ZIPATO may in its discretion replace the defective product (or any part thereof) with any reconditioned equivalent (or superior) product in all material respects to the defective product.

WARRANTOR

Tri plus grupa d.o.o.
Banjaveciceva 11
10 000 Zagreb
CROATIA

TEL +385 (0)1 4004 404
FAX +385 (0)1 4004 405

DECLARATION OF CONFORMITY



The manufacturer Tri plus grupa d.o.o declares under our sole responsibility that the product:

Marketing model: Smart Smoke Sensor
Regulatory model: hm-hs1sa-z
Trade/Brand name: Zipato

is in conformity with the Directive 2014/53/EU and carries the CE marking accordingly.

ETSI EN 300 220-1 V2.4.1 (2012-05)
ETSI EN 300 220-2 V2.4.1 (2012-05)

ETSI EN 301 489-1 V1.9.2 (2011-09)
ETSI EN 301 489-3 V1.6.1 (2013-08)

EN 62479: 2010

EN 60950-1: 2006+A11:2009+A1:2010+A12:2011+A2:2013

Changes or modifications not expressly approved by Tri plus grupa d.o.o. for compliance could void the user's authority to operate the equipment.

→ DISPOSING AND RECYCLING YOUR PRODUCT

When it reaches end of life, dispose of the product according to your local environmental laws, guidelines and regulations.



This symbol on the product or packaging means that according to local laws and regulations needs to be disposed of separately from household waste. Once this product has reached the end of its life, please take it to a collection point (recycle facilities) designated by your local authorities, some will accept your product for free or simply drop it off at your Zipato re-seller store. By recycling the product and its packaging in this manner you help to conserve the environment and protect human health. At Zipato, we understand and are committed to reducing any impact our operations and products may have on the environment. To minimize this impact Zipato designs and builds its products to be as environmentally friendly as possible, by using recyclable, low toxic materials in both products and packaging.

→ COPYRIGHT

© 2017 Tri plus grupa d.o.o. All Rights Reserved.
No part of this manual may be reproduced or transmitted in any form without the expressed, written permission of Tri plus grupa d.o.o.